

## EN 1092-1 TYPE 05 PN6 (BLIND)

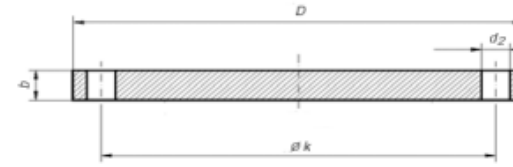

DN	k	D	b	d2	Thread	Number of drills	Weight kg
15	55	80	12	11	M10	4	0,437
20	65	90	14	11	M10	4	0,657
25	75	100	14	11	M10	4	0,821
32	90	120	14	14	M12	4	1,175
40	100	130	14	14	M12	4	1,390
50	110	140	14	14	M12	4	1,623
65	130	160	14	14	M12	4	2,141
80	150	190	16	18	M16	4	3,432
100	170	210	16	18	M16	4	4,220
125	200	240	18	18	M16	8	6,102
150	225	265	18	18	M16	8	7,502
200	280	320	20	18	M16	8	12,301
250	335	375	22	18	M16	12	18,537
300	395	440	22	22	M20	12	25,459
350	445	490	22	22	M20	12	31,763
400	495	540	22	22	M20	16	38,482
450	550	595	24	22	M20	16	51,213
500	600	645	24	22	M20	20	60,096

EN 1092-1  
TYPE 05A PN6